

DR7; Recessed QR111 100W Max

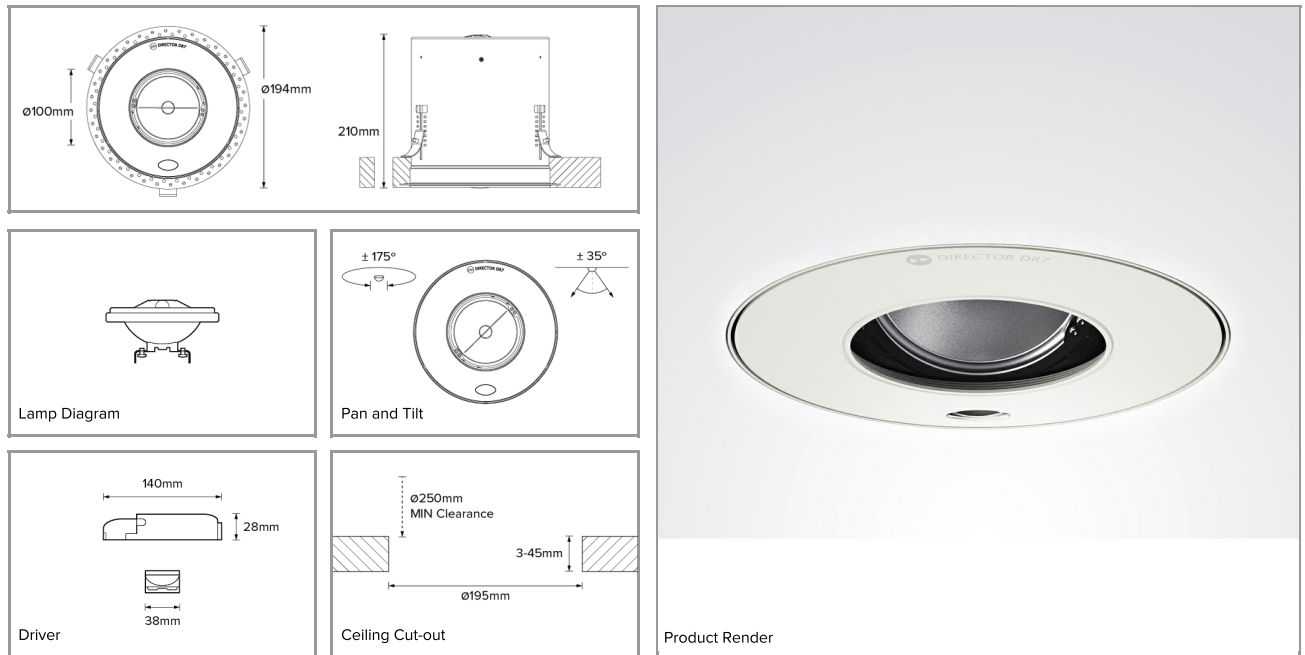

PHYSICAL

CONSTRUCTION MATERIALS:	LM24 Aluminium Glass-filled Polycarbonate Mild Steel mounting ring
MOUNTING:	Recessed
WEIGHT:	2.57kg
FINISH:	White RAL9010
MAX AMBIENT TEMPERATURE:	40°C
CEILING CLEARANCE:	250mm
CEILING CUT-OUT:	195mm
CEILING THICKNESS:	3-45mm

CONTROL

MOVEMENT TYPE:	Handheld Remote
DIMMING OPTION:	Handheld Control

SPECIFICATION

DR7 QR111 (100W Max) trimless recessed luminaire. Manufactured from LM24 aluminium and glass-filled polycarbonate, with a mild-steel mounting ring. Finished in white (RAL 9010). Voltage is 220-240V 50/60HZ. Luminaire can be rotated, with +/- 175° movement through the pan axis and +/- 35° through the tilt axis, at a resolution of less than 1° in either axis. Movement and dimming is controlled using a handheld remote. Recording and recalling of scenes as standard.

PART NO. **DR7.0055**

PRODUCT SUMMARY DR7 Spotlight; 220-240V 50/60Hz; Trimless Mounting; QR111 100W Max; White; Movement & Dimming using Handheld Remote

DR7; RECESSED QR111 100W Max

MOVEMENT

MOVEMENT TYPE: Handheld Remote
 PAN MOVEMENT RANGE: $\pm 175^\circ$
 TILT MOVEMENT RANGE: $\pm 35^\circ$
 PAN MOVEMENT RESOLUTION: $< 1^\circ$
 TILT MOVEMENT RESOLUTION: $< 1^\circ$
 PAN SPEED OF MOVEMENT: $25^\circ/s$
 TILT SPEED OF MOVEMENT: $7^\circ/s$

LIGHTING

LIGHT SOURCE: Halogen
 MIN. DISTANCE FROM TARGET: 1.5m
 GLARE MECHANICAL CUT-OFF: 27°
 GLARE COMFORT CUT-OFF: 55°

ELECTRICAL

VOLTAGE REGION: 220 - 240V 50/60Hz
 IEC PROTECTION CLASS: Class 1
 LIGHT SOURCE WATTAGE: 100W Max
 MOVEMENT WATTAGE: 4W
 LUMINAIRE CIRCUIT WATTAGE: Upto 104W
 CONTROL GEAR: Remote Halogen Transformer

PART NO. **DR7.0055**

PRODUCT SUMMARY DR7 Spotlight; 220-240V 50/60Hz; Trimless Mounting; QR111 100W Max; White; Movement & Dimming using Handheld Remote