

BO 55 basic / wls surface / semi-recessed

xal.com/bo



Quickinfo

GENERAL

surface mounted
IP20
several mounting options

LED

COB LED module
up to 84 lm/W
2700K, 3000K, 4000K
CRI ≥ 90
Binning initial ≤ 3 MacAdam

ESTIMATED LED LIFETIME

L80/50000h

OPTICAL

direct illumination
beam angle 6°, 14°, 23°, 33°

ELECTRICAL

non DIM

PHYSICAL

aluminium
powder-coated

Description

DE Strahlerelement aus Aluminiumdruckguss; Oberfläche weiß oder schwarz pulverbeschichtet; Strahlerkopf 355° dreh- und 90° schwenkbar; wahlweise mit Aufbaueinheit oder als Deckeneinbauvariante; Konverter im Strahlerkopf integriert; COB (Chip on Board) Technologie für höchste Effizienz; keine Bildung von Mehrfachschatten; energieeffiziente LEDs mit sehr guter Farbwiedergabe; Binning initial ≤ 3 MacAdam; lieferbar in den Lichtfarben 2700K, 3000K und 4000K; CRI ≥ 90; min. 80% des Lichtstromes nach 50000h Lebensdauer wahlweise mit hochwertiger Linsenoptik mit präziser Abstrahlcharakteristik; bzw. hochwertiger Reflektor mit sphärischer Facettenoptik, präzise Abstrahlcharakteristik mit drei verschiedenen Ausstrahlwinkeln; werkzeuglos einsetz- bzw. austauschbar; Schutzart IP20; SK II

EN Spotlight element in die-cast aluminium; surface powder coated in white or black; spotlight head 355° rotatable and 90° tiltable; either with surface mounted housing or as ceiling recessed variant; converter integrated into spotlight head; COB (Chip on Board) technology for maximum efficiency; no multiple shadows; energy-efficient LEDs with very good colour rendering; binning initial ≤ 3 MacAdam; available in the light colours 2700K, 3000K and 4000K; CRI ≥ 90; min. 80% of the luminous flux after 50000 hours; with optional high-quality lens system with precise radiation characteristic; and high-quality reflector with spherical facet effect design, precise radiation characteristic with three different beam angles; installed and exchanged without tools; protection class IP20; PC II

BO 55 basic
track

[page 680](#)



Features



glare-free due to
recessed LED

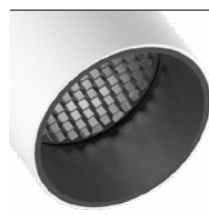

honeycomb louver as
accessory

Standard configuration

MOUNTING	
semi-recessed	8
surface	9

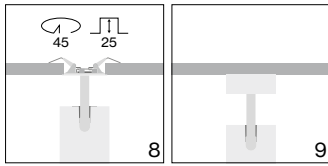

COLOUR TEMPERATURE	
3000K	5

CONTROL	
non DIM	

MATERIAL COLOUR	
white	7
black	8



REFLECTOR	
flood 33°	F

Extended configuration

COLOUR TEMPERATURE	
2700K	4
4000K	6

REFLECTOR	
spot 14°	S
medium 23°	M

LED LENS	
super spot 6° (only for BO 55 wls)	V

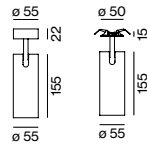

BO 55 basic

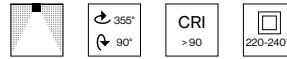

SYSTEM POWER	COLOUR TEMP.	LUMINOUS FLUX	ORDER CODE
21 W	2700K	1340lm	0 5 3 - 3 0 0 1 :: 1
	3000K	1540lm	
	4000K	1650lm	

luminous flux spot 14°

LIGHT DISTRIBUTION for 3000K

spot 14°			medium 23°			flood 33°		
h (m)	E (lx)	ø (m)	h (m)	E (lx)	ø (m)	h (m)	E (lx)	ø (m)
1	12907	ø0,25	1	6769	ø0,40	1	3625	ø0,68
2	3227	ø0,51	2	1692	ø0,81	2	906	ø1,37
3	1434	ø0,76	3	752	ø1,21	3	403	ø2,05
4	807	ø1,01	4	423	ø1,61	4	227	ø2,74
5	516	ø1,26	5	271	ø2,02	5	145	ø3,42

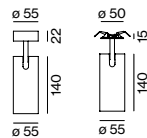

BO 55 wls

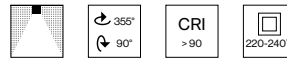

SYSTEM POWER	COLOUR TEMP.	LUMINOUS FLUX	ORDER CODE
10 W	2700K	620lm	0 5 3 - 3 0 0 0 :: 1
	3000K	710lm	
	4000K	710lm	

luminous flux spot 14°

LIGHT DISTRIBUTION for BO 55 basic wls, 3000K

super spot 6°			spot 14°		
h (m)	E (lx)	ø (m)	h (m)	E (lx)	ø (m)
1	22562	ø0,11	1	6667	ø0,25
2	5640	ø0,21	2	1666	ø0,50
3	2506	ø0,32	3	740	ø0,76
4	1410	ø0,43	4	416	ø1,01
5	902	ø0,53	5	266	ø1,26

medium 23°			flood 33°		
h (m)	E (lx)	ø (m)	h (m)	E (lx)	ø (m)
1	2905	ø0,40	1	1801	ø0,60
2	726	ø0,80	2	450	ø1,20
3	322	ø1,21	3	200	ø1,80
4	181	ø1,61	4	112	ø2,40
5	116	ø2,01	5	72	ø3,00

Optical accessories

HONEYCOMB LOUVER

TYPE	Ø-H (mm)	ORDER CODE
honeycomb louver	50-3	0 0 7 - 1 9 6 5 1 9 8

Inspiration

Speisesaal Eurac
Bolzano, Italy

PRODUCT
BO 55 basic semi-recessed

ARCHITECT

Roland Baldi architects
Bolzano, Italy

LIGHTING DESIGN

Eurolicht S.r.l.
Bolzano, Italy

