

LENO

trim

xal.com/leno



Quickinfo

GENERAL

recessed with trim
ceiling thickness 12,5 mm
↓ IP 40 / ↑ IP 20
quick installation

LED

Mid-power LED
up to 2007 lm/m
up to 126 lm/W
3000 K, 4000 K
CRI ≥ 80
Binning initial ≤ 3 MacAdam

ESTIMATED LED LIFETIME

L80/50 000 h

OPTICAL

direct light 100 %
HPO PMMA cover opal
microprismatic (UGR < 19)

ELECTRICAL

220–240 V
non DIM, DIM DALI

PHYSICAL

aluminium
powder-coated

LENO

trim system
page 560



Description

DE Extrem flacher Einbaukanal mit 14 mm Höhe; geeignet für den Einbau in 12,5 mm Decken, mit umlaufendem Rand; geeignet für die Wand- oder Deckenmontage; Oberfläche weiß pulverbeschichtet; einfache Montage ohne Schneiden der Unterkonstruktion; absturzgesicherter Lichteinsatz aus stranggepresstem Aluminiumprofil werkzeuglos mittels Magnethalter in Kanal einsetzbar; seitlich eingekoppeltes Licht durch LGP-Body (Light-Guiding-Prism) und hocheffizientem Reflektor nach unten gelenkt; homogen ausgeleuchtete, satinierte oder mikroprismatische Abdeckung aus PMMA; bildschirmtaugliche Arbeitsplatzleuchte nach DIN EN 12464-1 (UGR < 19); energieeffiziente LEDs mit sehr guter Farbwiedergabe; Binning initial ≤ 3 MacAdam; lieferbar in den Lichtfarben 3000 K und 4000 K; CRI ≥ 80; min. 80 % des Lichtstromes nach 50 000 h Lebensdauer Schutzart IP 40 unten (oben IP 20); SK II; inkl. externem Konverter für Deckeneinwurf; optional nicht dimmbar

EN Low profile recessed channel, height 14 mm; suitable for installation in 12.5 mm ceilings, with trim; suitable for wall or ceiling mounting; surface white powder coated; easy mounting without need to cut the substructure; fall-safe light insert made of extruded aluminium profile, can be inserted in the canal without tools by magnetic holders; side coupled light, directed downwards by LGP body (Light Guiding Prism) and highly efficient reflector; homogeneously illuminated, satinised or microprismatic PMMA cover; workplace light suitable for VDUs according to DIN EN 12464-1 (UGR < 19); energy-efficient LEDs with very good colour rendering; binning initial ≤ 3 MacAdam; available in the light colours 3000 K and 4000 K; CRI ≥ 80; min. 80 % of the luminous flux after 50 000 hours; protection class from below IP 40 (from above IP 20); PC II; incl. external converter for ceiling insertion; optional non-dimmable

Features



flat inset (11 mm)
UGR < 19

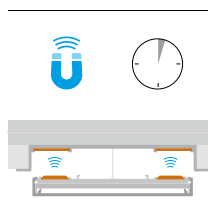

magnetic holders for
tool-free mounting

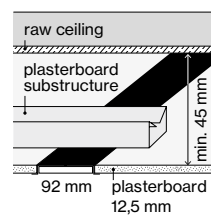

plasterboard
installation

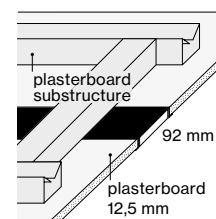

alternative installation

Standard configuration

COLOUR TEMPERATURE ⋮
3000K 5

CONTROL ⬆
DIM DALI 3

MATERIAL COLOUR
white



LIGHT OPTIC COVER
opal high performance

Extended configuration

COLOUR TEMPERATURE ⋮
4000K 6

CONTROL ⬆
non DIM 1

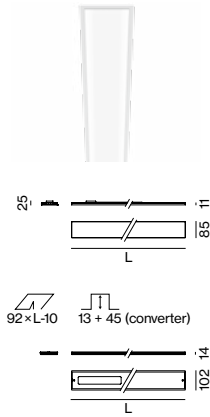
LIGHT OPTIC COVER
microprismatic (UGR < 19)



LENO trim, opal high performance

INSET + CHANNEL TRIM

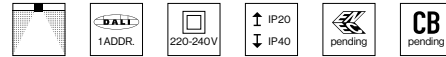

SYS. POWER	COLOUR TEMP.	LUM. FLUX	L (mm)	ORDER CODE
11W	3000K	1150lm	629	0 5 1 - 8 4 1 2 ⋮ 7 H
19W	4000K	1220lm	1237	0 5 1 - 8 4 1 4 ⋮ 7 H
29W	3000K	2300lm	1846	0 5 1 - 8 4 1 4 ⋮ 7 H
39W	4000K	2450lm	2454	0 5 1 - 8 4 1 6 ⋮ 7 H
	3000K	3450lm		0 5 1 - 8 4 1 6 ⋮ 7 H
	4000K	3670lm		0 5 1 - 8 4 1 8 ⋮ 7 H
	3000K	4600lm		0 5 1 - 8 4 1 8 ⋮ 7 H
	4000K	4890lm		0 5 1 - 8 4 1 8 ⋮ 7 H

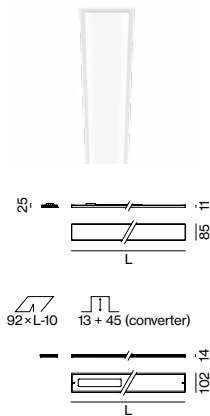

LENO trim, microprismatic

INSET + CHANNEL TRIM



SYS. POWER	COLOUR TEMP.	LUM. FLUX	L (mm)	ORDER CODE
11W	3000K	1090lm	629	0 5 1 - 8 4 1 2 ⋮ 7 G
19W	4000K	1160lm	1237	0 5 1 - 8 4 1 4 ⋮ 7 G
29W	3000K	2180lm	1846	0 5 1 - 8 4 1 4 ⋮ 7 G
39W	4000K	2310lm	2454	0 5 1 - 8 4 1 6 ⋮ 7 G
	3000K	3260lm		0 5 1 - 8 4 1 6 ⋮ 7 G
	4000K	3470lm		0 5 1 - 8 4 1 8 ⋮ 7 G
	3000K	4350lm		0 5 1 - 8 4 1 8 ⋮ 7 G
	4000K	4620lm		0 5 1 - 8 4 1 8 ⋮ 7 G

LIGHT DISTRIBUTION

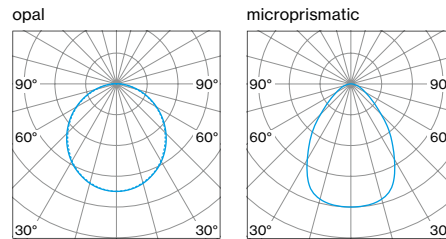

Accessories



DISMOUNTING TOOL

TYPE	ORDER CODE
vacuum cup	0 8 6 - 3 0 0 0 0

Technical data

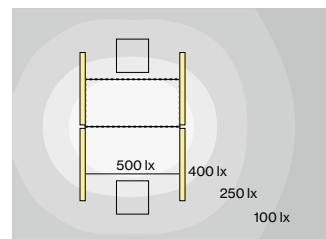

LENO trim, 19W, 4000K

ROOM VALUES

Room dimensions	5.4 × 4 × 2.8 m
Reflection factor	0.7 0.5 0.2
Maintenance factor	0.8

CALCULATION SURFACE

Surface dimensions	1.6 × 0.8
Surface height	0.75
Average illuminance (E _m)	> 500 lx
Uniformity (U ₀)	> 0.6

GLARE EVALUATION

Table Classification X=4H Y=8H S=0.25H	
UGR transversal	< 19
UGR axial	< 19
65° < 3000 cd/m ²	

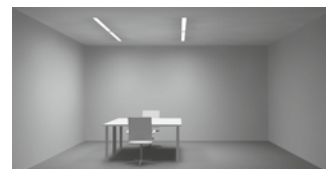

Inspiration

Pro Medico
Graz, Austria

ARCHITECT
INNOCAD Architektur ZT
Graz, Austria

PRODUCT
LENO trim
LENO system trim





LENO

trimless

xal.com/leno



Quickinfo

GENERAL

recessed trimless
ceiling thickness 12,5 mm
↓ IP 40 / ↑ IP 20
quick installation

LED

Mid-power LED
up to 2007 lm/m
up to 126 lm/W
3000 K, 4000 K
CRI ≥ 80
Binning initial ≤ 3 MacAdam

ESTIMATED LED LIFETIME

L80/50 000 h

OPTICAL

direct light 100 %
HPO PMMA cover opal
microprismatic (UGR < 19)

ELECTRICAL

220–240 V
non DIM, DIM DALI

PHYSICAL

aluminium
powder-coated

LENO

trimless system
[page 564](#)



Description

DE Extrem flacher Einbaukanal mit 13 mm Höhe; geeignet für den randlosen Einbau in 12,5 mm Gipskartondecken; geeignet für die Wand- oder Deckenmontage; Oberfläche weiß pulverbeschichtet; spezielle Randausbildung mit Rillen für bessere Haftung der Spachtelmasse; einfache Montage ohne Schneiden der Unterkonstruktion; absturzesicherer Lichteinsatz aus stranggepresstem Aluminiumprofil werkzeuglos mittels Magnethalter in Kanal einsetzbar; seitlich eingekoppeltes Licht durch LGP-Body (Light-Guiding-Prism) und hocheffizientem Reflektor nach unten gelenkt; homogen ausgeleuchtete, satinierte oder mikroprismatische Abdeckung aus PMMA; bildschirmtaugliche Arbeitsplatzleuchte nach DIN EN 12464-1 (UGR < 19); energieeffiziente LEDs mit sehr guter Farbwiedergabe; Binning initial ≤ 3 MacAdam; lieferbar in den Lichtfarben 3000 K und 4000 K; CRI ≥ 80; min. 80 % des Lichtstromes nach 50 000 h Lebensdauer Schutzart IP 40 unten (oben IP 20); SK II; inkl. externem Konverter für Deckeneinwurf; optional nicht dimmbar

EN Low profile recessed channel, height 13 mm; suitable for rimless installation in 12.5 mm plasterboard ceilings; suitable for wall or ceiling mounting; surface white powder coated; special edge design with grooves for better adhesion of filler; easy mounting without need to cut the substructure; fall-safe light insert made of extruded aluminium profile, can be inserted in the canal without tools by magnetic holders; side coupled light, directed downwards by LGP body (Light Guiding Prism) and highly efficient reflector; homogeneously illuminated, satinised or microprismatic PMMA cover; workplace light suitable for VDUs according to DIN EN 12464-1 (UGR < 19); energy-efficient LEDs with very good colour rendering; binning initial ≤ 3 MacAdam; available in the light colours 3000 K and 4000 K; CRI ≥ 80; min. 80 % of the luminous flux after 50 000 hours; protection class from below IP 40 (from above IP 20); PC II; incl. external converter for ceiling insertion; optional non-dimmable

Features



flat inset (11 mm)
UGR < 19

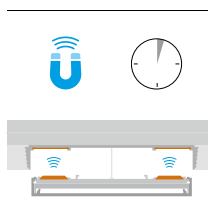

magnetic holders for
tool-free mounting

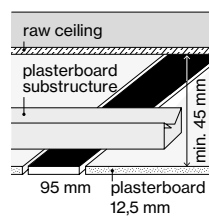

plasterboard
installation

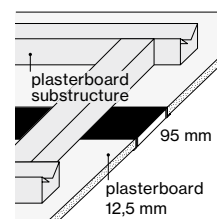

alternative installation

Standard configuration

COLOUR TEMPERATURE ⋮
3000K 5

CONTROL ⬆
DIM DALI 3

MATERIAL COLOUR
white



LIGHT OPTIC COVER
opal high performance

Extended configuration

COLOUR TEMPERATURE ⋮
4000K 6

CONTROL ⬆
non DIM 1

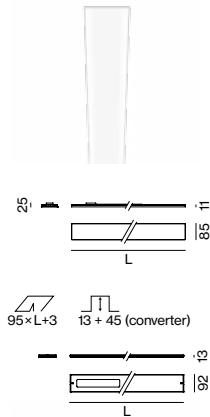
LIGHT OPTIC COVER
microprismatic (UGR < 19)



LENO trimless, opal high performance

INSET + CHANNEL TRIMLESS

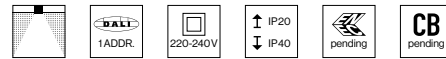

SYS. POWER	COLOUR TEMP.	LUM. FLUX	L (mm)	ORDER CODE
11W	3000K	1150lm	616	0 5 1 - 8 3 1 2 ⋮ 7 H
19W	4000K	1220lm	1224	0 5 1 - 8 3 1 4 ⋮ 7 H
29W	3000K	2300lm	1833	0 5 1 - 8 3 1 6 ⋮ 7 H
	4000K	2450lm		
39W	3000K	3450lm	2441	0 5 1 - 8 3 1 8 ⋮ 7 H
	4000K	3670lm		
	3000K	4600lm		
	4000K	4890lm		

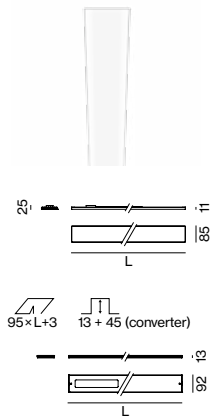

LENO trimless, microprismatic

INSET + CHANNEL TRIMLESS



SYS. GOWER	COLOUR TEMP.	LUM. FLUX	L (mm)	ORDER CODE
11W	3000K	1090lm	616	0 5 1 - 8 3 1 2 ⋮ 7 G
19W	4000K	1160lm	1224	0 5 1 - 8 3 1 4 ⋮ 7 G
29W	3000K	2180lm	1833	0 5 1 - 8 3 1 6 ⋮ 7 G
	4000K	2310lm		
39W	3000K	3260lm	2441	0 5 1 - 8 3 1 8 ⋮ 7 G
	4000K	3470lm		
	3000K	4350lm		
	4000K	4620lm		

LIGHT DISTRIBUTION

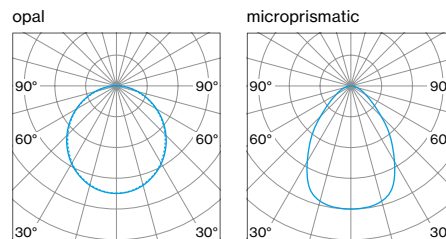

Accessories



DISMOUNTING TOOL

TYPE	ORDER CODE
vacuum cup	0 8 6 - 3 0 0 0

Technical data

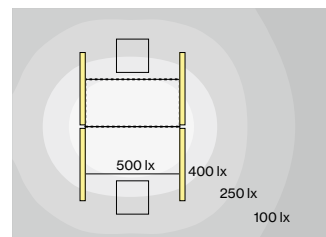

LENO trimless, 19W, 4000K

ROOM VALUES

Room dimensions	5.4 × 4 × 2.8 m
Reflection factor	0.7 0.5 0.2
Maintenance factor	0.8

CALCULATION SURFACE

Surface dimensions	1.6 × 0.8
Surface height	0.75
Average illuminance (E _m)	> 500 lx
Uniformity (U ₀)	> 0.6

GLARE EVALUATION

Table Classification X=4H Y=8H S=0.25H	
UGR transversal	< 19
UGR axial	< 19
65° < 3000 cd/m ²	

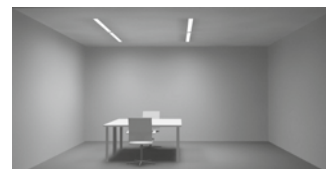

Inspiration

michael pachleitner group
Graz, Austria

ARCHITECT
GSarchitects
Graz, Austria

PRODUCT
LENO trimless



