

# BUBBLE 80

## trimless

[xal.com/bubble](http://xal.com/bubble)



### Quickinfo

#### GENERAL

recessed  
IP 20, IP 40  
plasterboard ceilings only

#### LED

COB LED module  
up to 86lm/W  
2700K, 3000K, 4000K, CWD  
CRI ≥ 90  
Binning initial ≤ 3 MacAdam

#### ESTIMATED LED LIFETIME

L80/50 000h

#### OPTICAL

direct illumination  
beam angle 6°, 27°, 37°  
optical accessories

#### ELECTRICAL

non DIM, DIM DALI

#### PHYSICAL

gypsum housing  
aluminium inset  
powder-coated

#### BUBBLE

trimless  
[page 176](#)



### Description

**DE** Hyperbolisch geformtes Einbaugehäuse aus Gips (überstreichbar); für randlosen Einbau in Gipskartondecken; abgerundete Innenkontur; geeignet für Deckenstärken von 10-25 mm; ruhiges Deckenbild durch zurückversetzte Leuchtebene; ein Strahler (SASSO) werkzeuglos einsetzbar durch Kugelschnappsystem; 360° dreh- und 35° schwenkbar; Oberfläche weiß, silbergrau oder schwarz pulverbeschichtet; optische Aufsätze sind als Zubehör erhältlich; passive Kühlung der LEDs durch optimierte Kühlkörpergeometrie; COB (Chip on Board) Technologie für höchste Effizienz; keine Bildung von Mehrfachschatten; energieeffiziente LEDs mit sehr guter Farbwiedergabe; Binning initial ≤ 3 MacAdam; lieferbar in den Lichtfarben 2700K, 3000K und 4000K; optional mit CWD (Colour Warm Dimming); CRI ≥ 90; min. 80% des Lichtstromes nach 50 000h Lebensdauer hochwertiger Reflektor mit sphärischer Facettenoptik; präzise Abstrahlcharakteristik mit drei verschiedenen Ausstrahlwinkeln; werkzeuglos einsetz- bzw. austauschbar; Schutzart IP 20 oder IP 44; SK II; optional DALI-dimmbar

**EN** Hyperbolic shaped installation housing made of plaster (paintable); for trimless installation in plasterboard ceilings; rounded internal contour; suitable for ceiling thickness of 10-25 mm; uncluttered ceiling look through recessed lighting level; one spotlight (SASSO), installation with ball catch system, without tools; 360° rotatable and 35° tiltable; surface white, silver-grey or black powder coated; optical attachments available as accessories; passive cooling of LEDs with optimised heat sink geometry; COB (Chip on Board) technology for maximum efficiency; no multiple shadows; energy-efficient LEDs with very good colour rendering; binning initial ≤ 3 MacAdam; available in the light colours 2700K, 3000K and 4000K; optional with CWD (Colour Warm Dimming); CRI ≥ 90; min. 80% of the luminous flux after 50 000 hours; high quality reflector with spherical facet finish; precise radiation characteristic with three different beam angles; installed and exchanged without tools; protection class IP 20 or IP 44; PC II; optional DALI dimmable

### Features



exchangeable light engine



patented ball catch system



skimmed into plasterboard ceiling (trimless)

### Standard configuration

**COLOUR TEMPERATURE** ◆◆  
3000K 5

**CONTROL** ◆◆  
non DIM 1

**MATERIAL COLOUR** ■  
white 7



**REFLECTOR** ▲  
flood 37° F

### Extended configuration

**COLOUR TEMPERATURE** ◆◆  
2700K 4  
4000K 6

**CONTROL** ◆◆  
DIM DALI 3

**MATERIAL COLOUR** ■  
silver-grey G  
black 8



+5% surcharges

**REFLECTOR** ▲  
medium 27° M

**LENS** ▲  
super spot 6° (only 8W non DIM) V

### Options on request

**CONTROL**  
phase-cut DIM

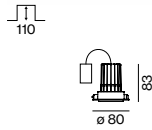

### INSET SASSO 80 flush



SYS. POWER	COLOUR TEMP.	LUMINOUS FLUX	ORDER CODE	
8 W	2700K	630lm	0 4 8 - 2 3 1 0 <span style="color: blue;">◆</span> <span style="color: blue;">▲</span>	
	3000K	660lm		
	4000K	700lm		
10 W CWD	1800-3000K (CRI ≥ 95)		0 4 8 - 2 3 1 0 0 3 <span style="color: blue;">■</span> <span style="color: blue;">M</span>	
	12 W	2700K		0 4 8 - 2 3 1 2 <span style="color: blue;">◆</span> <span style="color: blue;">▲</span>
		3000K		
	4000K	1050lm		
12 W IP 44	3000K	980lm	8 4 8 - 2 3 1 2 5 <span style="color: blue;">◆</span> <span style="color: blue;">F</span>	

### LIGHT DISTRIBUTION for 12W, 3000K

super spot 6° (8W)			medium 27°			flood 37°		
h (m)	E (lx)	ø (m)	h (m)	E (lx)	ø (m)	h (m)	E (lx)	ø (m)
1	21750	ø0,11	1	2534	ø0,48	1	1826	ø0,68
2	5437	ø0,21	2	633	ø0,96	2	456	ø1,36
3	2416	ø0,32	3	281	ø1,44	3	202	ø2,03
4	1359	ø0,43	4	158	ø1,92	4	114	ø2,71
5	870	ø0,53	5	101	ø2,40	5	73	ø3,39

### Optical accessories

TYPE	ORDER CODE
honeycomb louver	0 4 8 - 2 0 9 1 3 1 <span style="color: blue;">■</span>
linear prismatic lens	0 4 8 - 2 0 9 2 3 1 <span style="color: blue;">■</span>
snoot	0 4 8 - 2 0 9 1 1 1 <span style="color: blue;">■</span>
snoot with honeycomb louver	0 4 8 - 2 0 9 1 2 1 <span style="color: blue;">■</span>

use only 1 optical accessory

### Mounting accessories

#### BUBBLE 80

**TRIMLESS MOUNTING HOUSING 80**  
for installation in plasterboard ceilings 10-25mm

TYPE	ORDER CODE
1 lamp	0 6 0 - 0 2 8 1 7

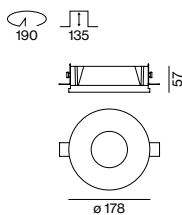

## Inspiration

Eggersmann Showroom  
Hiddenhausen, Germany

**ARCHITECT**  
BKS Architekten  
Lübbecke, Germany

**PRODUCT**  
BUBBLE 80 trimless



